

RECOMMENDED CIRCUIT PATTERN
PER IPC-D300 TYPE II, CLASS C
(COMPONENT SIDE)

- 1 HOUSING MATERIAL: LIQUID CRYSTAL POLYMER.
- 2 CONTACT MATERIAL: PHOSPHOR-BRONZE.
- 3 CONTACT FINISH:(D)
UNDERPLATE (ENTIRE CONTACT):
0.00127 MIN NICKEL PER SAE-AMS-QQ-N-290
ON MATING SURFACES:
FLASH GOLD PER ASTM B 488, OVER
0.00076 MIN PALLADIUM-NICKEL OVER UNDERPLATE, OR
0.00076 MIN GOLD [ER ASTM B 488 OVER UNDERPLATE.
ON LEADS:
0.00381 MIN MATTE TIN PER ASTM B 545 OVER UNDERPLATE.
LUBRICATION (MIN MATING SURFACES):
SURFACE CONDITIONER AFTER PLATING.

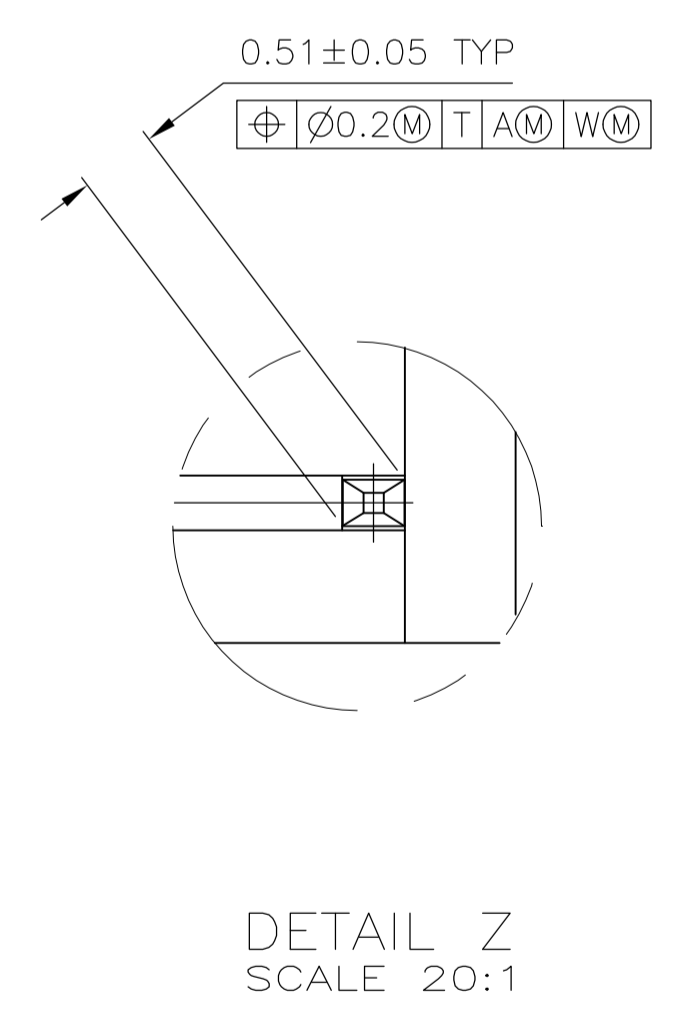

10	5	6	1	11.88	3	8	5536607-1
E	D	C	B	A	FINISH	NO OF POSN	PART NUMBER
THIS DRAWING IS A CONTROLLED DOCUMENT.				D.R. BENDER 08/10/92		STE TE Connectivity	
DIMENSIONS: mm				CHK S.HEADER 01/25/93		NAME	
TOLERANCES UNLESS OTHERWISE SPECIFIED:				APVD		PRODUCT SPEC	
0. PLC ± -				PRODUCT SPEC		APPLICATION SPEC	
1. PLC ± -				APPLICATION SPEC		SIZE CASE CODE DRAWING NO	
2. PLC ± .13				APPLICATION SPEC		RESTRICTED TO	
3. PLC ± -				APPLICATION SPEC		A1 00779 C=5536607	
4. PLC ± -				APPLICATION SPEC		WEIGHT	
ANGLES ± -				APPLICATION SPEC		CUSTOMER DRAWING	
MATERIAL				FINISH		SCALE 4:1 SHEET 1 OF 1 REV A3	